

FITS SERIES 2 & 3 ATTACHMENTS

STALL TYPE INSTALLATION
2.38mm JIFFY KEY

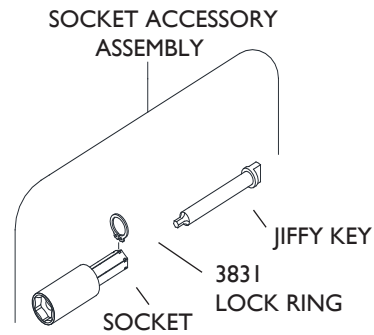
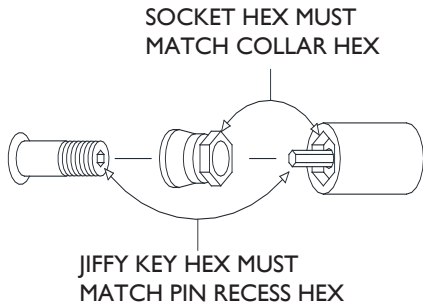

LENGTH OF SOCKET mm

JIFFY KEY HEX	SOCKET HEX	DESCRIPTION	6.35	12.7	25.4	38.1	50.8	63.5	76.2
2.38mm 3/32"	7mm	SOCKET ACCESSORY ASSEMBLY	21188	21189	21190	21191	21192	21193	21194
		SOCKET	19616	19617	19618	19619	19620	19621	19622
		JIFFY KEY 2.38mm STALL	18141	18142	18143	18144	18145	18146	18147
	8mm	SOCKET ACCESSORY ASSEMBLY	21195	21196	21197	21198	21199	21200	21201
		SOCKET	19623	19624	19625	19626	19627	19628	19629
		JIFFY KEY 2.38mm STALL	18141	18142	18143	18144	18145	18146	18147
	9.5mm	SOCKET ACCESSORY ASSEMBLY	21202	21203	21204	21205	21206	21207	21208
		SOCKET	19630	19631	19632	19633	19634	19635	19636
		JIFFY KEY 2.38mm STALL	18141	18142	18143	18144	18145	18146	18147
	10mm	SOCKET ACCESSORY ASSEMBLY	19777	19778	19779	19780	19781	19782	19783
		SOCKET	19637	19638	19639	19640	19641	19642	19643
		JIFFY KEY 2.38mm STALL	18141	18142	18143	18144	18145	18146	18147
	11mm	SOCKET ACCESSORY ASSEMBLY		19785	19786	19787	19788	19789	19790
		SOCKET		19645	19646	19647	19648	19649	19650
		JIFFY KEY 2.38mm STALL		18142	18143	18144	18145	18146	18147

Denotes special use Socket Accessory Assembly for limited access areas.

For best results pins should not protrude through installed collars more than two threads.